

## CIM 727

### BALANCING VALVE AND FLOW MEASUREMENT VALVES



#### SERVICE RECOMMENDATIONS :

The Cimberio Commissioning set is a combined double regulating valve and separate flow measurement device, which provides high accuracy flow balancing, and measurement across all valve settings. The commissioning sets are suitable for both heating (LPHW) and cooling applications at working pressure up to 20 bar. Valve sizes between 15-50 mm are available as "CR" brass oblique pattern globe valves.

The valves have been tested by BSRIA (Building Services Research and Information Association).

#### CROSS SECTION

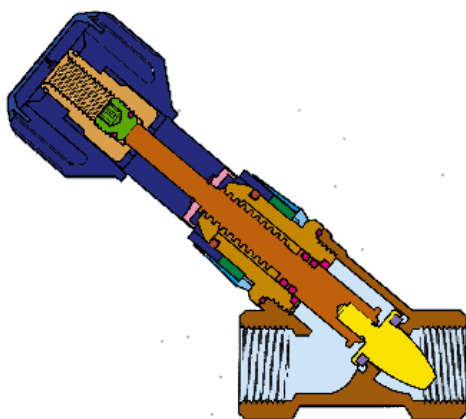

BODY :	BRASS CC752S
BONNET :	HOT FORGED BRASS EN 12165 CW 602N
STEM :	HOT FORGED BRASS EN 12165 CW 602N
DISC FACE :	EPDM
SHUTTER :	HOT FORGED BRASS EN 12165 CW 602N
O-RING :	HNBR
INDEX :	HOSTAFORM
CIRCLIP :	BRONZE
1/10 TURN INDEX :	HOSTAFORM
TURN INDEX :	HOSTAFORM
MEMORY M12 :	HOT FORGED BRASS EN 12165 CW 602N
O-RING :	HNBR
PIN :	STEEL
O-RING :	HNBR
KNOB :	NYLON
ENTRAINER :	HOT FORGED BRASS EN 12165 CW 602N
CAP :	HOSTAFORM
ELASTIC RING :	AISI302

## FLOW AND PRESSURE DROP

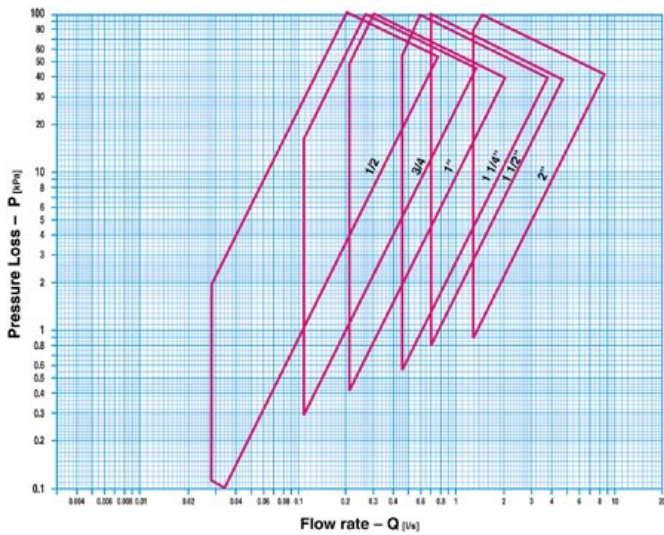

Flow and pressure drop  
 1 l/min = 0,06 m<sup>3</sup>/h  
 1 m<sup>3</sup>/h = 16,67 l/min

## PRESSURE TEMPERATURE RATINGS

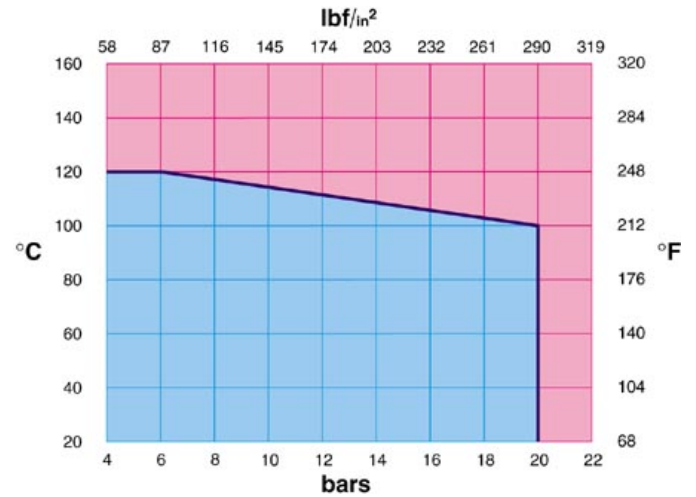

Pressure / temperature ratings  
 1 bar = 14,5 p.s.i.  
 $^{\circ}\text{C} = 5/9 (^{\circ}\text{F}-32)$   
 $^{\circ}\text{F} = 32+9/5 ^{\circ}\text{C}$

## TECHNICAL DRAWING

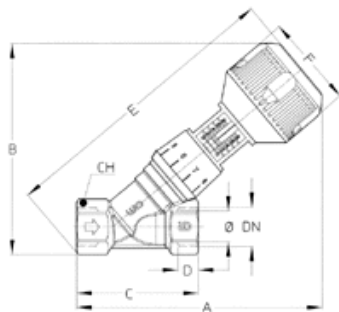

DN	1/2"	3/4"	1"	1 1/4"	1 1/2"	2"
Grma.	475	645	845	1277	1855	2860
A	137,5	157	160	171	212	231
B	119	138,5	154	168,5	211	230
C	68	77	91	108	116	143
D	15	16,3	19,1	21,4	21,4	25,7
E	162,5	190	201,5	220	276	301,6
F	52	52	52	52	58	58
CH	28	33	40	51	56	71

Connection:  
 ISO 7 RP (Parallel)

## TECHNICAL CHARACTERISTICS

### KV

DN	1/2"	3/4"	1"	1 1/4"	1 1/2"	2"
KV	3,905	7,281	11,757	21,600	28,461	50,519

KV = Capacity in m<sup>3</sup>/h at pressure drop of 1 bar

KVS = Water flow generated by a pressure loss of 1 bar measured on the test points.